

# MUSEUM

floor by floor

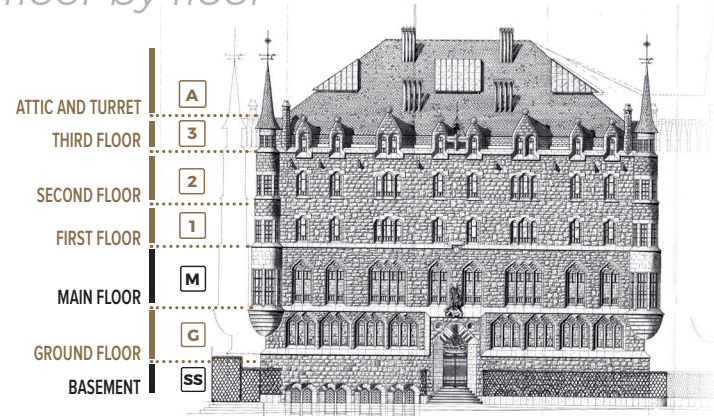

## G GROUND FLOOR

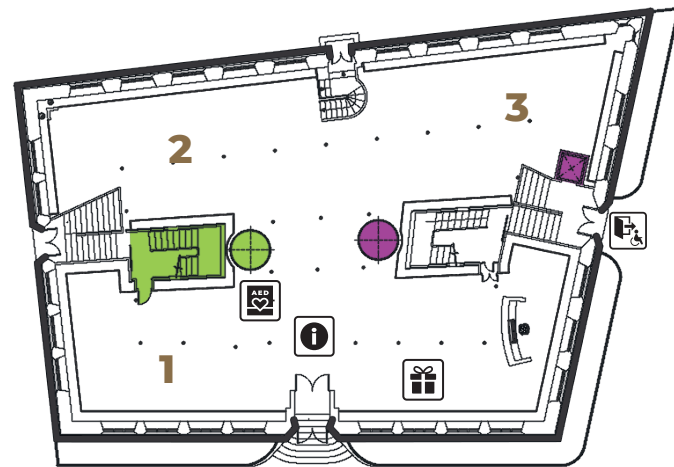

- 1 - History of Casa Botines
- 2 - Fernández y Andrés' textile shop (1893)
- 3 - León's Caja de Ahorros y Monte de Piedad (1931)

## 1 FIRST FLOOR



- 4 - Library (by prior arrangement: [info@casabotines.es](mailto:info@casabotines.es))
- 5 - Temporary exhibition halls
- 6 - Educational area
- 7 - Children's workshops

## 3 THIRD FLOOR

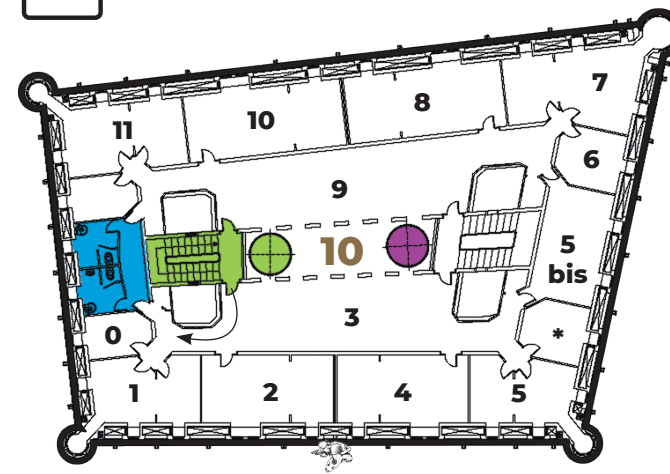

- 10 - The Fine Arts Collection
- To navigate through this floor, you may use its specific brochure.

## 2 SECOND FLOOR



- 8 - Gaudi's Universe
- 9 - The 19th-century apartment
- 1 - Entrance hall
- 2 - Master bedroom
- 3 - Bedroom
- 4 - Living room
- 5 - Kitchen
- 6 - Maid's bedroom
- 7 - Dentist's

## A ATTIC AND TURRET

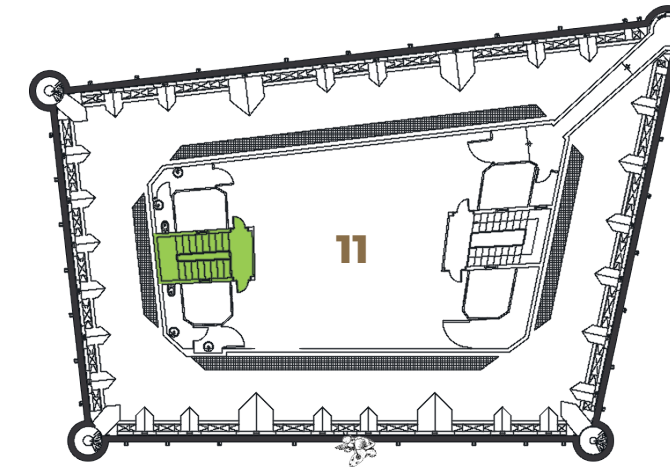

- 11 - The FUNDOS collection: bibliographical and documentary heritage
- 12 - 1893's original turret

## VISITOR GUIDELINES

- Please leave your phone on silent mode and speak quietly.
- During your visit, you can follow the arrows and other signage dotted about the exhibition to follow the recommended order, as well as the Museum map. In addition, you can make use of all didactic material at your disposal, such as explanatory panels, exhibition signage or information sheets. We remind you that the latter must be returned to their proper place after your consultation. If you have any questions or need any assistance, do not hesitate to ask the Museum staff.
- The Museum provides an audio guide service in Spanish, English and French. You can activate it for free on your phone. For further information, please contact the museum staff.
- The exhibited works are very delicate and fragile. Please do not touch them and keep a safe distance. Thank you for your cooperation.
- To conserve the works of art, the rooms are kept in optimum conditions with regard to lighting, temperature and relative humidity. To ensure the isolation of the exhibition halls, please do not handle the lights or open doors and windows.
- Light discolours and damages many works of art. For that reason, you may find some halls in complete darkness. Do not worry, the light comes on automatically when you enter the room.
- As an institution committed to preserving the environment, all the exhibition halls in the Museum use LED technology.
- The halls will begin to be cleared 10 minutes before closing.
- If at the end of your visit you do not want to keep this brochure, please return it to the Museum staff. We hope you enjoy your visit.







## THE MUSEUM

In April 2017, the FUNDOS Foundation decided to restore a unique building that had always been closed to the public, the Casa Botines, designed by Antoni Gaudí in 1892. Its opening led to the creation of the Gaudí Casa Botines Museum, which conserves, researches and promotes the history and characteristics of the building and the figure of Antoni Gaudí (Ground and Second floors), the rich collection of the Foundation, especially its Fine Arts collection (Third Floor), and its documents and bibliography collection (Attic). The Museum is conceived as a dynamic force of social, economic, and cultural life in the area where it operates. It promotes cultural and educational activities to ensure access to our heritage and fosters the universal values of equality, liberty and environmental awareness.

## Opening hours

Monday to Sunday: 11am-2pm and 4-8pm  
Closed Wednesday mornings and Sunday evenings  
The opening hours might change. Please visit [www.casabotines.es](http://www.casabotines.es) for details

## Tickets

**General admission:** 8€ (concessionary rate: 5€)  
**Guided tour:** 12€ (concessionary rate: 8€)  
**Further information:** [www.casabotines.es](http://www.casabotines.es)

**Plaza de San Marcelo 5. 24002 León (Spain)**  
**Tel: (+34) 987 353 247 • [info@casabotines.es](mailto:info@casabotines.es)**

 Bus stop: Alfonso V: **L12 L4 L2**  
Santo Domingo: **A1 A3 A12 L8 L12**

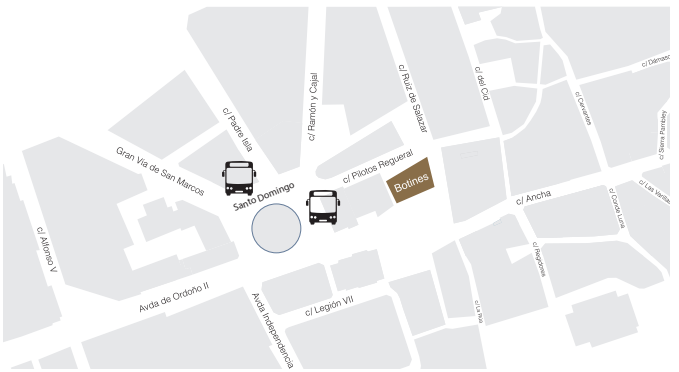

Get your tickets at  
[www.casabotines.es](http://www.casabotines.es)

   @casabotines



**ICOM** international  
council  
of museums

An initiative by:  
**FUNDOS**  
fundación

Your admission fee and purchases support the Museum.



## CASA BOTINES

Casa Botines (1889-1893) was the first tenement house designed by Gaudí, where the young architect (who was not even forty) used for the first time many structural, decorative and symbolic solutions which he would use again in his following works. Thus, he provided the ground floor, which was destined to hold the Fernández y Andrés' textile shop, with an extraordinary flexibility of use by substituting load-bearing walls with cast-iron pillars. On the upper floors, intended for housing, the functionality of wicket doors (made to carry furniture easier), sash windows, funnel patios (which distribute light and air) and the stairs, with their ergonomic banisters, mixes with the beauty of the peepholes and the doorknobs. All of this creates a beautiful, functional, modern and revolutionary building, as Gaudí's architectural ideas were.